



'Amaryllis'

Cruising in France

CRUISE ITINERARIES

'Amaryllis' cruises in Burgundy on the Canal de Bourgogne, River Saône and Canal du Centre, a route that is 80% canal and 20% river. She can also cruise a 100% canal route on the Canal de Bourgogne only. Itineraries with special themes (such as family and golf) can be arranged for special interests. 'Amaryllis' also offers special "Semaine des Grand Crus" (Wines of Burgundy) departures that can be booked by individuals.

All cruises are from Sunday through Saturday (six nights), with longer options available.

ON-BOARD ACCOMMODATIONS

The upper-deck cabin on board 'Amaryllis' as well as the lower-deck cabins can be configured as either king or twins. All cabins have marble en suite bathrooms and offer shower gel, body cream, hand soap, shampoo and a hairdryer. Two lower-deck cabins have a tub and shower; the others have showers only. Electrical current is 220V (standard European).

Each cabin also has a phone/intercom system that allows guests to communicate directly with crew members in the galley or salon.

NUMBER OF GUESTS / CHILD POLICY

This charter-only barge is best suited for parties of eight persons. Special pricing is offered for less-than-capacity chartering parties of six or seven persons.

MEALS DURING THE CRUISE

Gourmet dining is an integral part of the 'Amaryllis' experience. Menus are inspired by the culinary traditions for which France is known, and meals are prepared using the freshest ingredients from local markets; on occasion, interested guests may accompany the chef to the market. The wines and cheeses served on board are specially selected to enhance the dining experience.

Breakfast and lunch are served buffet style, while a set menu is offered at dinner. Guests with specific food requests can generally be accommodated with advance notice. Weather permitting, there is also the possibility of *al fresco* meal service on the outdoor sun deck.



CRUISE PRICE INCLUSIONS & EXCLUSIONS

The cruise price includes on-board accommodations for six nights; all meals from dinner on day of embarkation through breakfast on day of disembarkation; all alcoholic and non-alcoholic beverages on board; fully-guided sightseeing excursions (as indicated on the day-by-day itinerary), including entrance fees; and private

driver transfer between Paris and the barge embarkation/disembarkation points.

The cruise price does NOT include gratuities to crew, travel insurance or airfare.

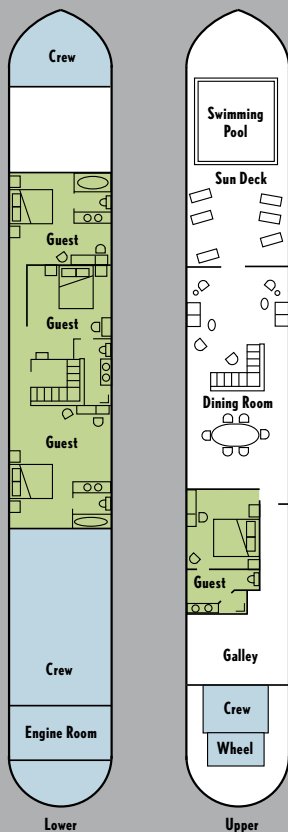

BARGE SPECIFICS

- Staffed by 6 crew members, including an on-board chef
- Barge is 128 feet long, 16.6 feet wide and has air conditioning and central heating
- Salon and separate dining area offer additional living space and include a television with DVD, a stereo system, an assortment of DVDs and CDs, a computer with Internet connection and a Bose iPod docking station for guests' use
- Exterior sun deck partially covered by a canopy for *al fresco* dining possibilities
- Heated 196-square-foot swimming pool on sun deck
- Barge not handicap accessible and is appropriate for those with only minor mobility issues
- Eight touring bicycles available for guests' use
- Strict non-smoking policy in effect on all interior areas of the barge
- No guest telephone access on board but ample opportunities ashore
- Euros only form of payment accepted on board