



## 'Elisabeth'

### Cruising in France

#### CRUISE ITINERARIES

'Elisabeth' cruises the lovely Burgundy Canal. Her popular "Chocolate & Wine" cruises, which include dessert-making demonstrations and local wine tastings, are offered all season. Itineraries with special themes — such as family, cooking or walking — can be arranged for chartering parties with special interests.

All cruises from Saturday through Friday (six nights), with longer options available for chartering parties.

#### ON-BOARD ACCOMMODATIONS

The three cabins on board 'Elisabeth' are carpeted. Each cabin is 150 square feet in size. Beds can be made up as either one queen or two twins. Electrical current is 220V AC (standard European). There is a single basin in each bathroom. Body wash, shampoo, cotton swabs and tissue are provided for guests. One robe per guest and a hair dryer are also provided in each cabin.

#### NUMBER OF GUESTS / CHILD POLICY

The family-friendly 'Elisabeth' is best suited for chartering parties of six persons and welcomes younger children. (There is special pricing for less-than-capacity chartering parties of four or five persons.)

Individual cabin bookings are accepted on a limited number of departures, with children over 16 welcome on hotel sailings.

#### MEALS DURING THE CRUISE

Gourmet dining is an integral part of the 'Elisabeth' experience, which includes local wine pairings and chocolate-inspired desserts. Menus are designed to capture the culinary traditions for which France is known and are prepared with the freshest local ingredients. Interested guests may, on occasion, accompany the on-board chef to market in the morning to join in selecting the day's produce. The wines and cheeses served on board are specially selected to enhance the dining experience.

Breakfast and lunch are served buffet style, and dinner offered with a set menu. Guests with specific food requests can generally be accommodated with advance notice. Weather permitting, there is also the possibility of *al fresco* meal service on the sun deck.



## CRUISE PRICE INCLUSIONS & EXCLUSIONS

The cruise price includes on-board accommodations for six nights; all meals from dinner on day of embarkation through breakfast on day of disembarkation; all alcoholic and non-alcoholic beverages on board; fully guided sightseeing excursions (as indicated on the day-by-day itinerary), including entrance fees; and transfers

between Paris and the barge embarkation/disembarkation points.

The cruise price does NOT include gratuities to crew, travel insurance or airfare.

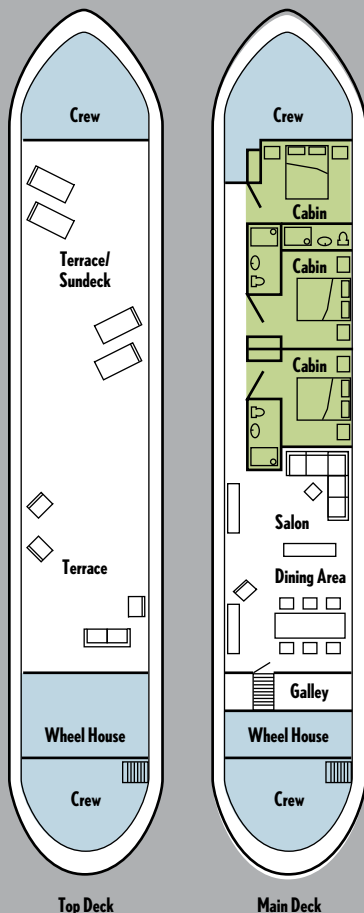

## BARGE SPECIFICS

- Owned and operated by Peter and Sheena Jenner, proud grandparents who enjoy children and have many years of barge experience
- Two other crew members on staff
- Cots, high chairs and child bicycles supplied for families with small children chartering 'Elisabeth'
- Barge is 100 feet long, 17 feet wide and has air conditioning and central heating
- Salon features comfortable seating (L-shaped sofa and chairs), with flat-screen television/DVD, CD player, library and games
- Exterior sun deck offers arm chairs, benches and a dining table for *al fresco* meals
- Covered wheel house can accommodate passengers on a bench seat behind captain
- Salon, dining and cabins on one deck for easy access
- Barge not handicap accessible and is appropriate for those with only minor mobility issues
- 21-speed, all-terrain bicycles available for guest use on towpaths along cruise route
- Strict non-smoking policy in effect in all interior areas
- Small dog on board that rarely ventures beyond the wheel house on top deck; can be boarded on request
- No telephone access for guests on board but ample opportunities ashore
- Euros only form of payment accepted on board