



'La Nouvelle Etoile'

Cruising in Holland, France and Germany

CRUISE ITINERARIES

'La Nouvelle Etoile' cruises Holland in the flower-filled springtime on a route that is half canal and half river. In summer, she finds herself in France on one of four routes: Burgundy (10% canal and 90% river), Champagne (10% canal and 90% river), Alsace-Lorraine (entirely canal) or the Upper Loire (80% canal and 20% river). During the autumn harvest season, 'La Nouvelle Etoile' cruises a river route in the Moselle region of Germany.

Itineraries with special themes — such as family, cooking or walking — can be arranged for chartering parties with special interests.

All cruises are from Sunday through Saturday (six nights), with longer options available for chartering parties.

ON-BOARD ACCOMMODATIONS

The four cabins are each in excess of 200 square feet and have large, panoramic windows. Beds can be made up as either one double or two twins. Each cabin is equipped with satellite television, DVD and flat-screen TV, Internet access (with printer available in the exercise room), a telephone and safe deposit box. Electrical current is both 220V (standard European) and 110V (American). Each cabin has an en suite bathroom with two basins, an oversized shower, a hairdryer and one robe per guest.

NUMBER OF GUESTS / CHILD POLICY

'La Nouvelle Etoile' is best suited for couples, individuals or chartering parties of eight persons. Children over 18 are welcome on hotel sailings; children under 18 are welcome on charters.

MEALS DURING THE CRUISE

Gourmet dining is an integral part of the experience on board 'La Nouvelle Etoile.' Each dinner is an event — a carefully planned culinary experience, served on Wedgwood china with Christofle silver and fine crystal. The on-board chef procures the finest foodstuffs and freshest produce, seasoned with herbs grown right on board the barge. Meals are complemented by superior wines from the best local vineyards. From time to time and depending on cruise route, guests can accompany the chef to market in the morning.



Breakfasts and lunches are buffet style, and dinner is served with a set menu. Guests with specific food requests can generally be accommodated with advance notice.

Weather permitting, there is also the possibility of *al fresco* meal service under the canopy on the sun deck.

CRUISE PRICE INCLUSIONS & EXCLUSIONS

The cruise price includes on-board accommodations for six nights; all meals from dinner on day of embarkation through breakfast on day of disembarkation; all alcoholic and non-alcoholic beverages on board; fully guided sightseeing excursions (as indicated on the day-

by-day itinerary), including entrance fees; and transfers between Amsterdam/Paris/Strasbourg/Frankfurt (depending on itinerary) and the barge embarkation/disembarkation points.

The cruise price does NOT include gratuities to crew, travel insurance or airfare.

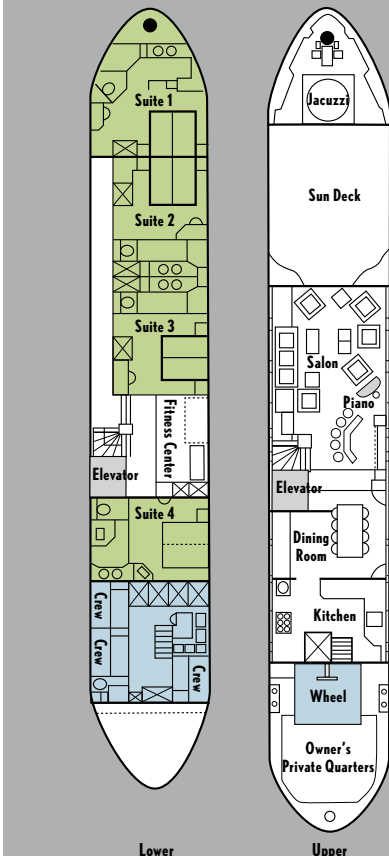

BARGE SPECIFICS

- Barge owned and operated by Jan and Diana Meijer, who are in their second decade of luxury barging
- On-board amenities include a small elevator and electric *terras* heating on the sun deck
- Staffed by five crew members
- Barge is 129 feet long and 18 feet wide, with air conditioning and central heating as well as optional fresh-air intake in all cabins
- Living area fitted with rich carpeting, whereas dining area has herringbone hardwood flooring
- CD player, piano and stereo available in salon for guests' enjoyment
- Barge has small library, exercise room and laundry room that guests may use
- Sun deck features comfortable, reclining lounge chairs; a spa pool; an herb garden; and a retractable, electric canopy for shade and *al fresco* dining
- Small elevator and wheelchair for physically challenged passengers, although barge is not handicap accessible
- Touring bicycles and helmets provided for guests' use
- Strict non-smoking policy in force for all interior areas of the barge
- Euros and U.S. dollars are only forms of payment accepted on board